



SHOP BY VEHICLE



0

INSTALL INSTRUCTIONS FOR 75-5092



PRINT

BEFORE YOU START

This intake kit may not fit with the following Aftermarket Parts installed:

Body Lift or Lowering Kit

Intercooler or Turbo upgrades

REQUIRED TOOLS

- 7mm Wrench or Socket
- 8mm Wrench or Socket
- 10mm Wrench or Socket
- 7/16" Wrench or Socket
- 5/16" Nut Driver or Flat Blade Screwdriver
- Phillips Screwdriver, Pliers or Channel locks

- Please read the entire product guide before proceeding.
- Ensure all parts are present.
- If you are missing any of the components, call our customer support at (909) 947-0015.
- Do not work on your vehicle while the engine is hot.
- Make sure the engine is turned off and the vehicle is in Park or the Parking Brake is set.

ENTER TO WIN



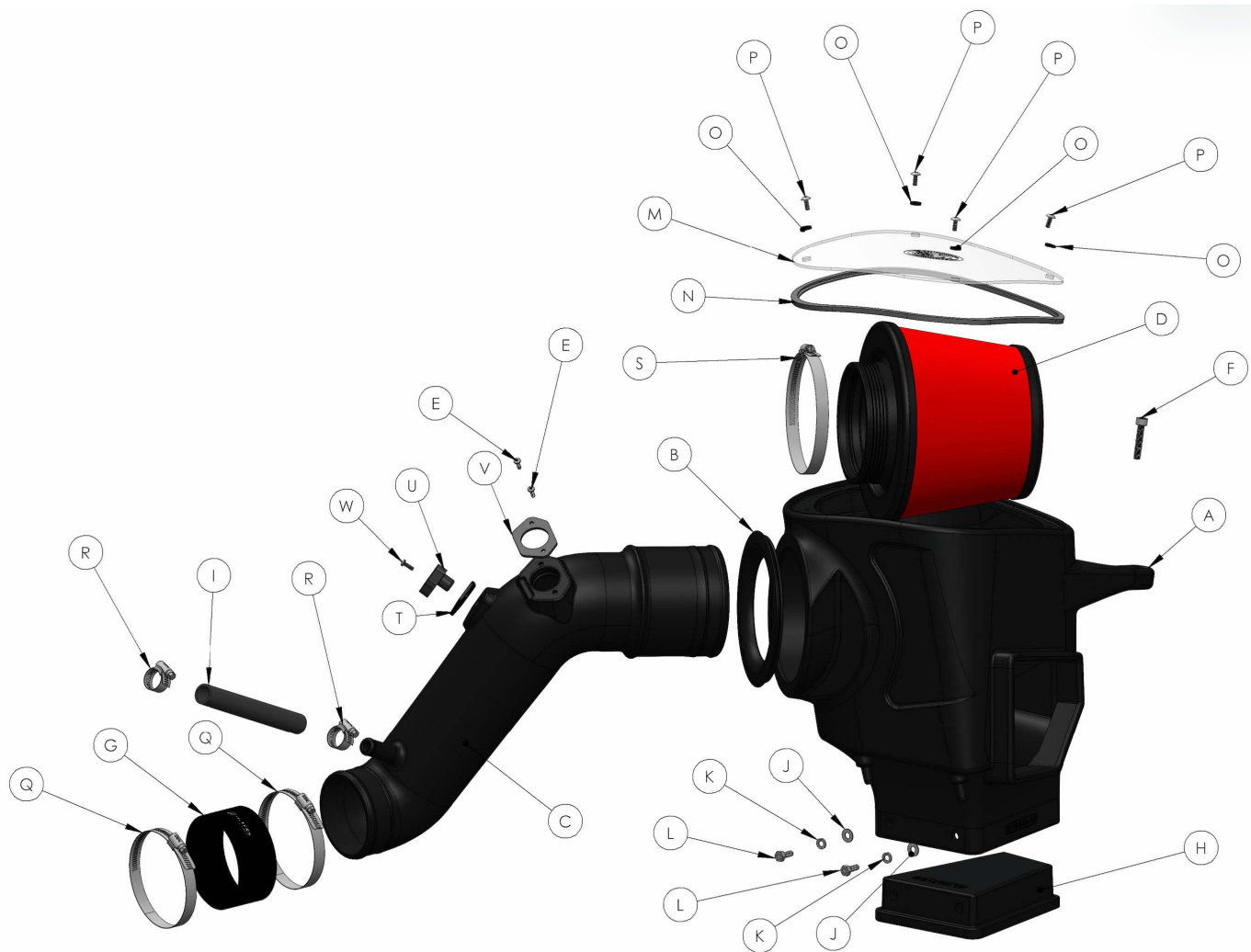

ITEM	QTY.	DESCRIPTION	P/N	ITEM	QTY.	DESCRIPTION	P/N
A	1	AIR BOX	AL1264B-00	O	4	WASHER, SEALING	AI1540-00
B	1	TUBE SEAL	AI1717C-00	P	4	SCREW, 10-24 X 1/2	AI1539-00
C	1	AIR INTAKE TUBE	AL1269-00	Q	2	HOSE CLAMP, #64	AG1018-00
D	1	AIR FILTER	KF-1053 of KF-1053D	R	2	HOSE CLAMP, #12	AG1030-00
E	2	SCREW, SS, 8-32 X 1/2	AI1479-00	S	1	HOSE CLAMP, #88	AG1011-00
F	1	SCREW, ALLEN HEAD	AI1369-00	T	1	IAT SENSOR GASKET	AI1954-00
G	1	COUPLER	AI1354C-00	U	1	IAT SENSOR SPACER	AI1955-00
H	1	BOX PLUG	AL1163-00	V	1	MAF SENSOR GASKET	AI1301-00
I	1	BREATHER HOSE	AI1040-00	W	1	SCREW, 8-32 X 1-1/8	AI1976-00
J	2	WASHER, FLAT 1/4-20	AI1073-00				
K	2	WASHER, LOCK 1/4-20	AI1309-00				
L	2	BOLT, HEX	AI1068-00				
M	1	LID	AI1613-00				
N	1	EDGE TRIM	AI1636-01				

STEP 1

With the ignition switched off and the parking brake set, disconnect the negative battery cables on both batteries.

IMPORTANT: Failure to disconnect the battery for a minimum of 2 hours may cause the Check Engine Light to illuminate upon completion of the installation or subsequent operation. **DO NOT SKIP THIS STEP!**



STEP 2

Disconnect the electrical harness connectors for the Intake Air Temp (IAT) and the Mass Air Flow (MAF) sensor then unsnap the wire loom from the tube. On the MAF sensor, slide the red locking tab up then press down on the tab and pull the connector out. For the IAT sensor, press down on the grey tab and pull the connector out.



STEP 2 (IMAGE 2)

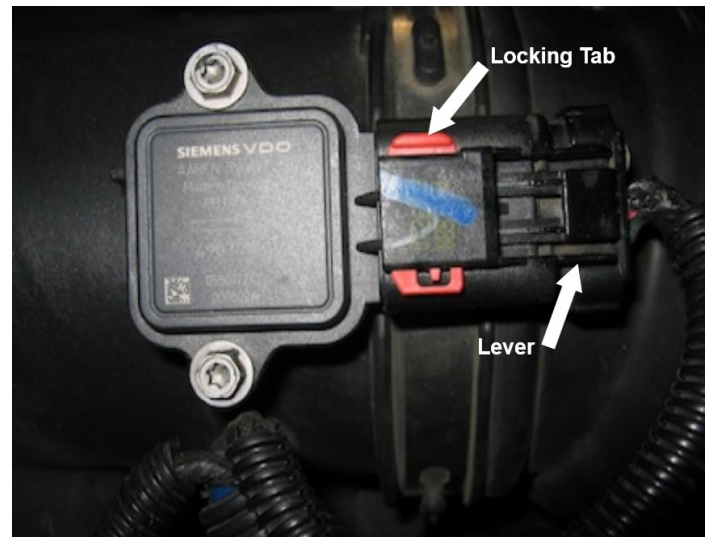

STEP 3

Loosen the hose clamp at the turbo inlet, next pinch the spring clamp and slide it up the CCV line. Pull off the silicone hose and remove spring clamp.

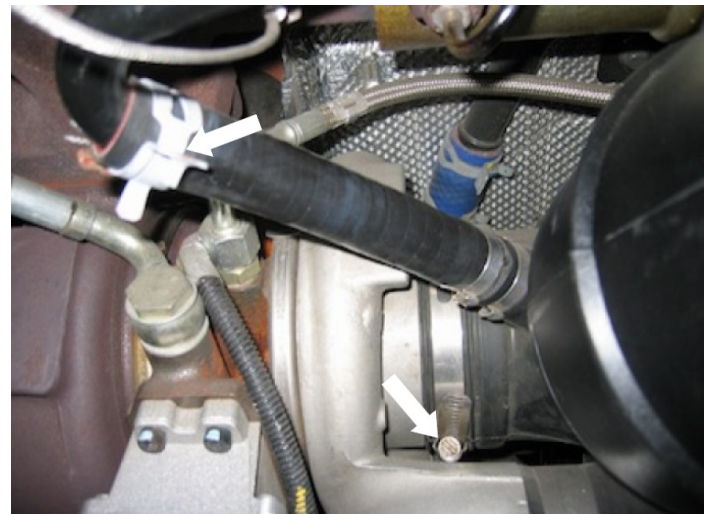

STEP 4

Remove the mounting nut on the core support securing the stock airbox.



STEP 5

Lift up and out to remove the stock airbox assembly from the vehicle.



STEP 6

Remove the plastic clip holding the coolant overflow tube to the fender. Remove the clip from the tube and rest the tube on the air inlet foam.



STEP 7

Carefully remove both MAF and IAT sensors from the stock intake tube and install them onto the Intake Tube (C). Use the supplied 8/32 Screws (E) and MAF Gasket (V) for the MAF sensor. Use the supplied 8/32 Screws (W), IAT Sensor Spacer (U), and IAT Sensor Gasket (T) for the IAT sensor. Do not overtighten.

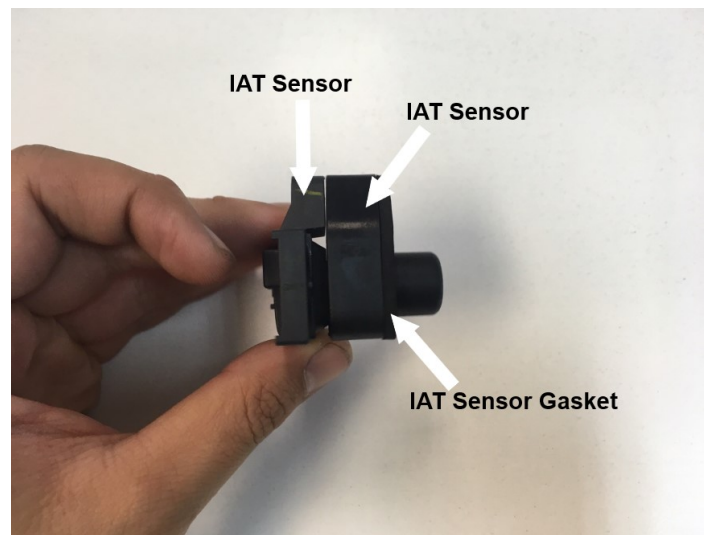

STEP 7 (IMAGE 2)



STEP 8

Install the Tube Seal (B) onto the Airbox (A).



STEP 9

For those concerned about minimal engine heat; install the Box Plug (H) into the bottom of the Airbox (A) using the provided Screws (L), Lock Washers (K) and Flat Washers (J). For those seeking additional airflow, set the box plug aside.

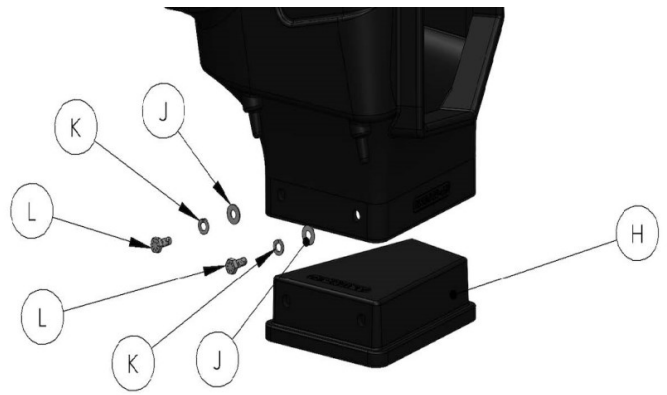

STEP 10

Slide the Coupler (G) and both #64 Hose Clamps (Q) onto the turbo as shown below. Tighten the clamp by the turbo. Leave the other clamp loose for now.



STEP 11

Place the Air filter (D) and Airbox (A) into the truck.



STEP 12

Install the Air Intake Tube (C) onto the turbo and slide the Breather Hose (I) onto the CCV line with the two #12 Hose Clamps (R) and spout on the air intake tube. Insert the other end of the air intake tube into the Airbox (A). You may have to lift the air box up a little bit to get the air intake tube through the Tube Seal (B). Tighten the hose clamp at the turbo and two hose clamp for the breather hose. Align the box prongs on the bottom of the air box with the grommets on the side of the battery tray and push down on the box to completely seat the prongs onto the grommet.



STEP 12 (IMAGE 2)

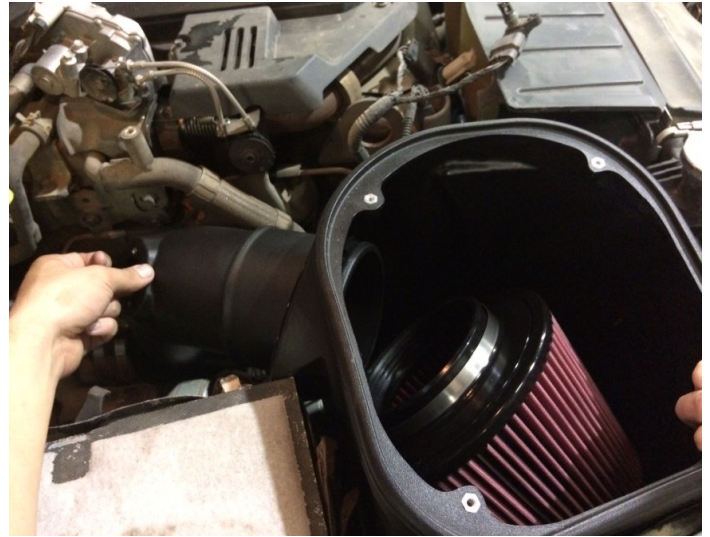

STEP 13

Use the supplied Allen Head Screw (F) to secure the Airbox (A).

STEP 14

Install the Air Filter (D) onto the Intake Tube (C) with the provided #88 Hose Clamp (S). Tighten the hose clamp.

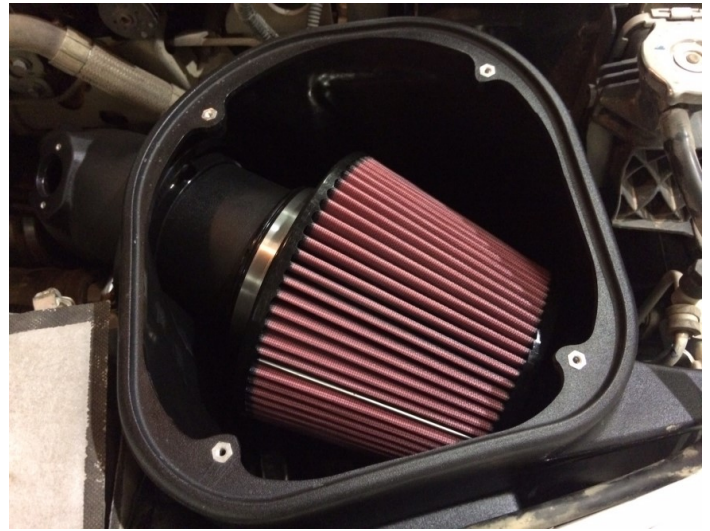

STEP 15

Reconnect the MAF and IAT electrical harness connectors. If necessary, zip ties the harness away from any engine components generating too much heat.



STEP 16

Remove the protective covering on the Clear Lid (M) and install the Edge Trim (N).



STEP 17

Place the Clear Lid (M) on top of the Airbox (A) using the supplied Screws (P) and Washers (O).

STEP 18

Reconnect the negative terminal on both batteries. Inspect your installation, make sure the kit is properly positioned and all fasteners are secure. Affix the ID label

near the intake kit. The installation is now complete.



WIN A FREE TOOL TRAY

Sign-up below to receive the latest on product launches, insider tips and more. You'll also be entered into a tool tray giveaway where we choose a new winner every week.

Email Address

Sign Up

