



SHOP BY VEHICLE



0

INSTALL INSTRUCTIONS FOR 75-5104



PRINT

BEFORE YOU START

- Please read the entire product guide before proceeding.
- Ensure all parts are present.
- If you are missing any of the components, call our customer support at (909) 947-0015.
- Do not work on your vehicle while the engine is hot.
- Make sure the engine is turned off and the vehicle is in Park or the Parking Brake is set.
- Note: This intake kit may not fit with the following Aftermarket Parts installed: Body Lift or Lowering Kit, Custom Hood, Throttle Body Spacer / Upgrade

REQUIRED TOOLS

- 8mm & 10mm Wrench/Socket
- 5/16" Nut Driver or Flat Blade Screwdriver
- T20 Torx (supplied)
- Phillips Screwdriver
- Scissors
- Panel Popper

ENTER TO WIN



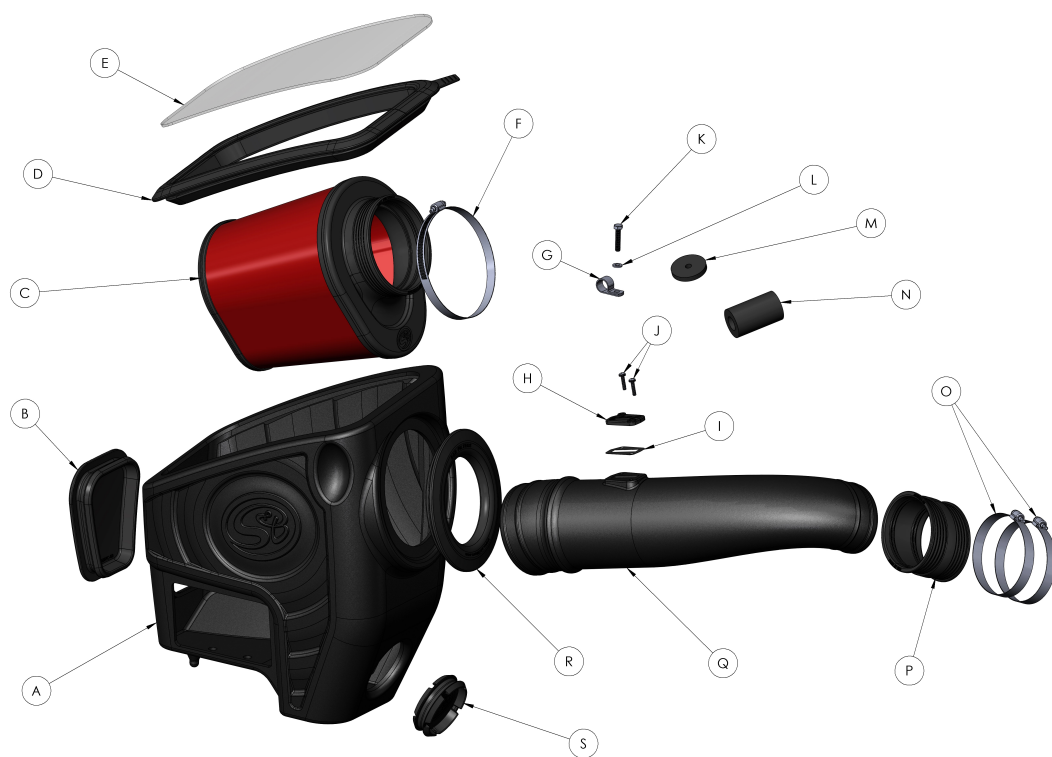

ITEM	PART NUMBER	DESCRIPTION	QTY.
A	AL1305B-01	AIRBOX	1
B	AI1597C-00	BOX PLUG	1
C	KF-1050	AIR FILTER	1
D	AI2247C-00	LID SEAL	1
E	AI2532-00	CLEAR LID	1
F	AG1010-00	HOSE CLAMP, #80	1
G	AI1511-00	LOOP CLAMP, 5/8" OD x 1/2" WIDE	1
H	AI1822-00	MAF PAD	1
I	AI1823-00	MAF GASKET	1
J	AI1837-00	SCREW, SEMS, #8-32 x 3/4"	2
K	AI1257-00	SCREW, HEX, M6 x 10mm	1
L	AI1416-00	WASHER, M6	1
M	AI1471-00	RUBBER WASHER	1
N	AI1522-01	INSULATION TUBE, 3/4" ID	1
O	AG1009-00	HOSE CLAMP, #72	2
P	AI1523C-00	COUPLER	1
Q	AL1305-00	INTAKE TUBE	1
R	AI1650C-00	TUBE SEAL	1
S	AI2249C-00	BOX PLUG	1
PARTS BELOW ARE NOT SHOWN IN THE EXPLODED VIEW			
T	AI1327-00	T-20 TORX KEY	1

STEP 1

Disconnect both the positive and negative cables from the passenger side battery and disconnect only the negative cable from the battery on the driver side.

IMPORTANT: Failure to disconnect the battery for a minimum of 2 hours may cause the Check Engine Light to illuminate upon completion of the installation or subsequent operation. **DO NOT SKIP THIS STEP!**



STEP 2

Disengage the red locking clip, press down on the tab, then pull out to disconnect the MAF sensor harness from the MAF sensor. Unclip the wiring harness from the stock intake lid.

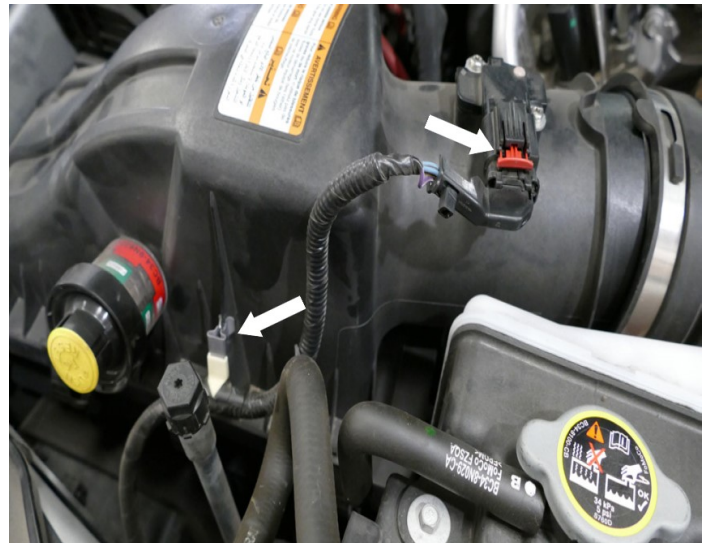

STEP 3

Loosen the hose clamp at the intake tube and unhook the four clips on the stock intake

lid. Remove the stock intake lid from the vehicle.

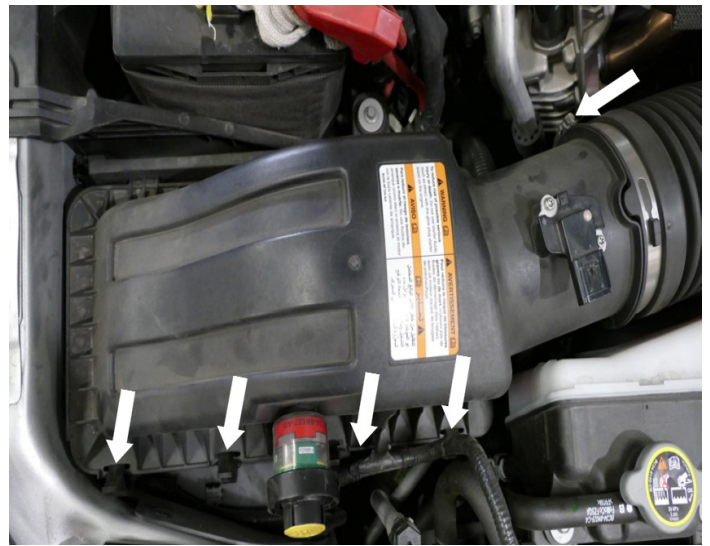

STEP 4

Loosen the hose clamp at the turbo inlet and remove the screw securing stock intake tube.

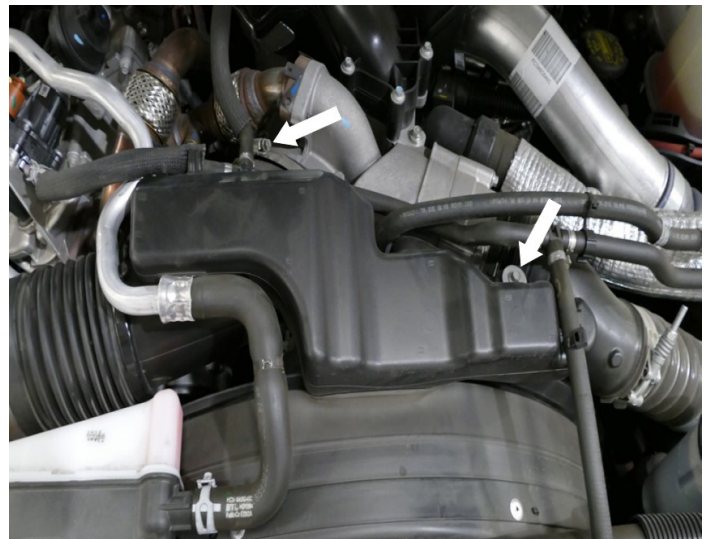

STEP 5

Disconnect all rubber hoses and coolant lines then remove the stock intake tube from the vehicle.

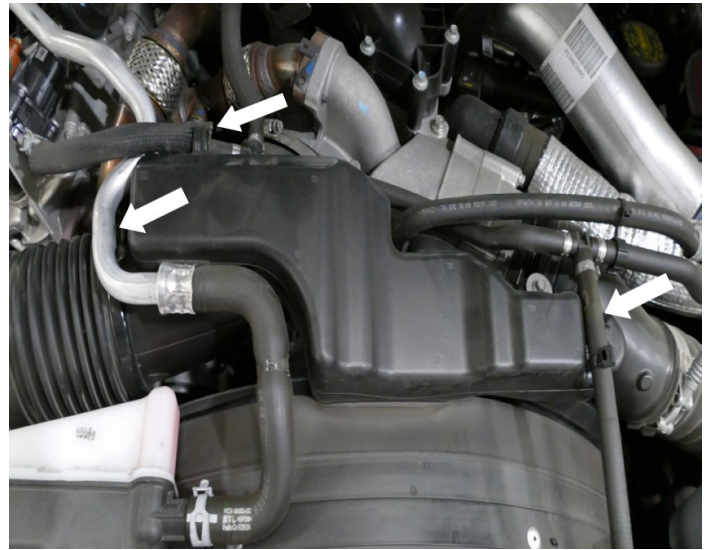

STEP 6

Remove the screw securing the air box to the battery tray. Set this screw aside, it will be reused in Step 14.



STEP 7

Carefully remove the stock airbox out of the vehicle. Check to make sure that the rubber grommets are still in the vehicle and did not get pulled out with the airbox.



STEP 8

Remove the stock intake inlet gasket from the stock airbox and install it onto the Airbox (A).



STEP 9

Install the Tube Seal (R) onto the Airbox (A).



STEP 10

With this intake kit we have included a breakaway Box Plug (S) that is designed to keep engine heat out of your airbox but also serves as a safety mechanism that will protect your engine in the event that the main inlet of the intake becomes blocked with debris.

Determine if you want to install the Box Plug (S) onto the Airbox (A) or leave it open. See the “Air Box Plug” for more information.

STEP 11

Determine if you want to install the Box Plug (B) onto the Airbox (A) or leave it open. See the “Airbox Plug” for more information.



STEP 12

If the Box Plug (B) is desired, simply press the Box Plug (B) into the box opening until it snaps into place.

STEP 13

Place the Rubber Washer (M) on top of the stock mounting clip on the battery tray.

STEP 14

Install the Airbox (A) into the vehicle, ensure the prongs are completely seated onto the stock grommets. Align the mounting tab, located on the backside of Airbox (A), with the stock mounting clip and Rubber Washer (M) then install the screw, removed in Step 6, and tighten.

STEP 15

Install the Coupler (P) and #72 Hose Clamps (O) onto the Intake Tube (Q). Slide the coupler over the intake tube as much as possible so it is flush with the end of the tube. This will provide additional clearance during installation. Leave the hose clamps loose.

STEP 16

Install the Intake Tube (Q) into the Airbox (A). First, start by feeding the tube underneath the A/C lines and through the Tube Seal (R). Note the angle of the tube for this step. The orientation of the tube will allow for an easier installation.

STEP 17

Rotate the Intake Tube (Q), to align it with the turbo inlet, then slide the Coupler (P) over the turbo inlet. Position the #72 Hose Clamps (O) to the side of the intake tube so that the hose clamp is not in direct contact with the rubber hoses. Tighten both hose clamps.

STEP 18

Carefully remove the MAF sensor from the stock intake tube and install it onto the Intake Tube (Q) with the 8-32 Screws (J), MAF Pad (H) and MAF Gasket (I).

STEP 19

Place the Air Filter (C) into the Airbox (A), slide it onto the Intake Tube (Q), then tighten the #80 Hose Clamp (F).

STEP 20

Remove the protective covering from the Clear Lid (E).

STEP 21

Stretch silicone lid seal around the perimeter of the clear lid. It should be a snug fit.

STEP 21B

The notch on the lid and the tab of the lid seal should mate in the same corner.

STEP 22

Press the Lid Seal (D) into the opening on the top of the Airbox (A) until it snaps into place.

STEP 23

Route the MAF sensor harness between the coolant line and reconnect it to the MAF sensor. Make sure to engage the red locking clip.

STEP 24

To protect the intake tube from the A/C line, remove the paper backing from the Insulation Tube (N), wrap it around the A/C line, then press the adhesive against the foam wrap to secure it around the A/C line.

STEP 25

Secure the coolant hose near the turbo inlet with the Loop Clamp (G), M6 Screw (K) and Washer (L) onto the

mounting location previously used by the stock intake tube in Step 4.

STEP 26

Reconnect all cables on both batteries, make sure the kit is properly positioned and all fasteners are secure. Keep all stock parts in case you ever need to reinstall them. Affix the ID label near the intake kit. The installation is now complete



WIN A FREE TOOL TRAY

Sign-up below to receive the latest on product launches, insider tips and more. You'll also be entered into a tool tray giveaway where we choose a new winner every week.

Email Address

Sign Up

